

NOTE* — Please maximize electrical power access throughout all zones and staff areas

ZONE A – Entry Space and Corridor to Back

- Long stretch that moves from front door down to back room

ZONE B – Yorick's Extension Zone

- Fluid, curvy zone
- Delineated floor space using floor and railing or half wall
- Drop ceiling
- Special lighting ("wow" lighting up front)
- Use windows
- Need to consider queue management
- Move furniture out of zone from hard to soft seating

ZONE C – Front "Help" Zone

- Area next to Yorick's
- Busy zone
- Plasma displays around stairwell for advertising services, etc.
- Use passive wall space to display reference collections according to subject areas (e.g., Literature, Biology, etc.)

ZONE D – Front Area Beyond Yorick's and Help Zone

- Collaborative study space
- Booths with computers for group study
- Because up front could be where we do higher end technology with booths vs. back room booths

ZONE E – Back Stairwell

- Can we put in window to add more light?
- Add some nature images make space more inviting

ZONE F – Quiet Study Zone

- Back staff office area
- Place for access to subject librarian help

ZONE G – Back Room-Quiet Study Room

- Where Reference is now
- More computers
- We need to break this out more into different zones probably

ZONE H - Outside of Building

- Outdoor Seating
- Welcoming transition into building

ZONE I - Media Lab

- Media Lab Space
- Sound booth

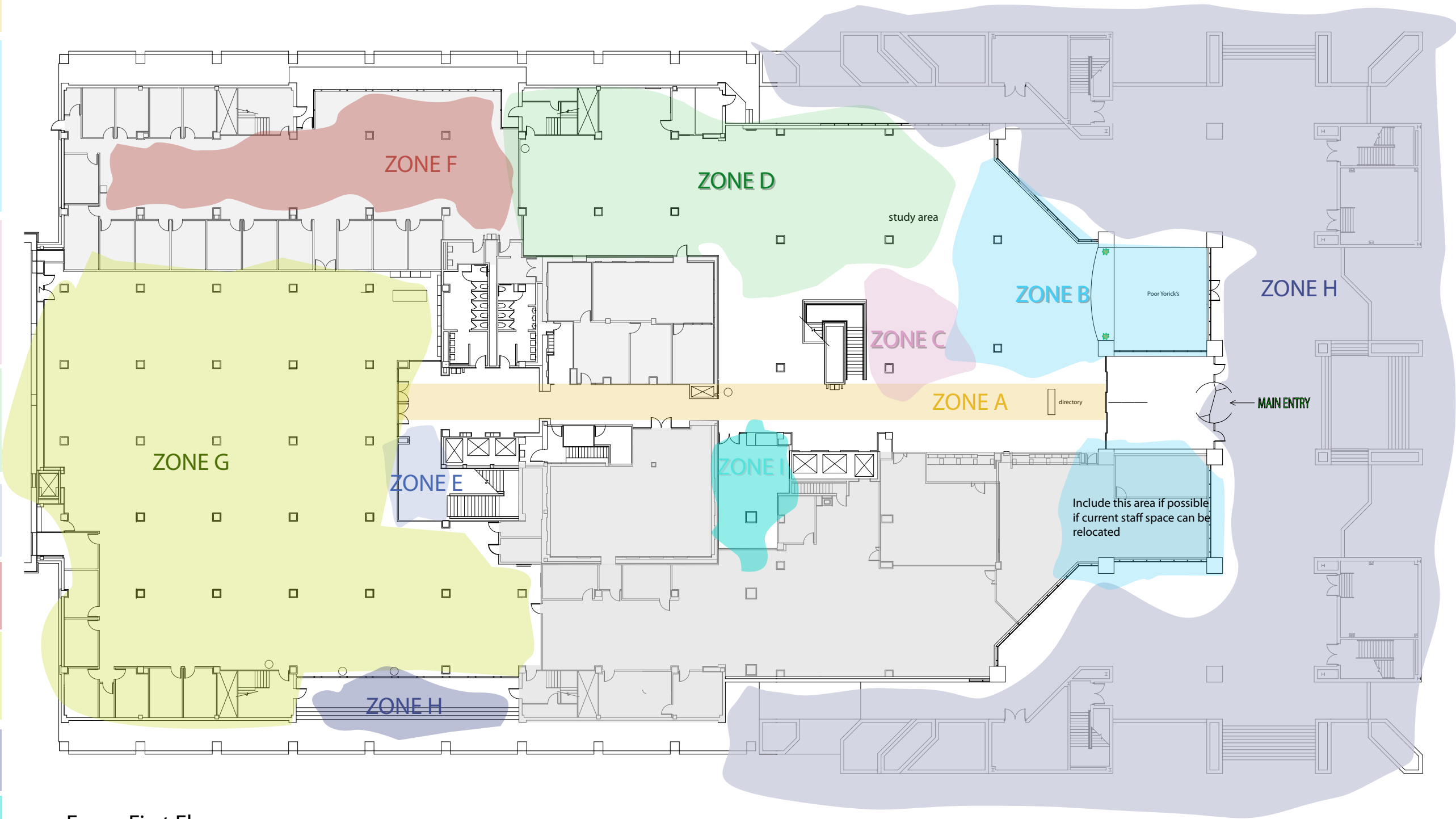

Evans First Floor