

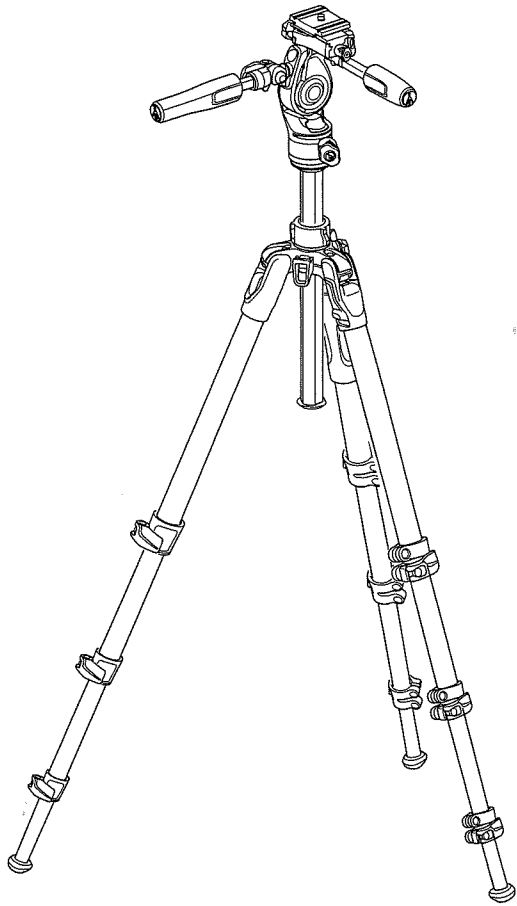





Befree Advanced
Tripod



INSTRUCTIONS
MKBFRLA4BK-3W

151 cm 2 kg 6 kg
 59.44" 4.4 lbs 13.2 lbs



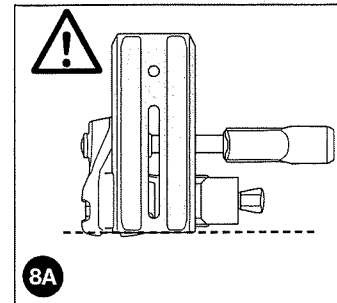
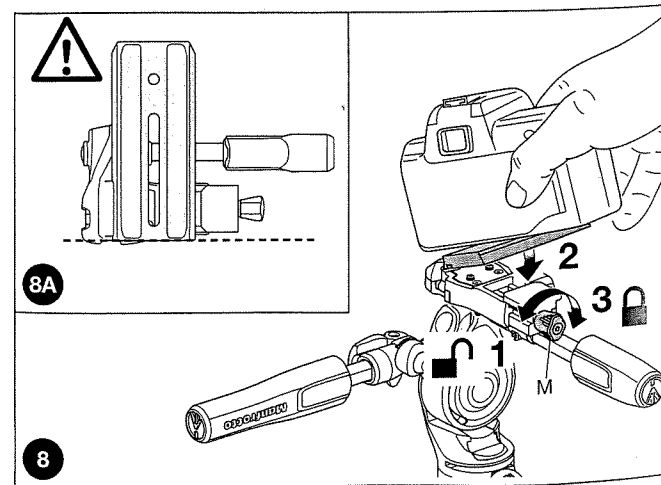
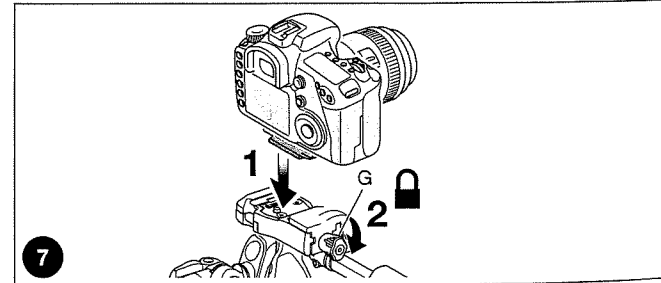
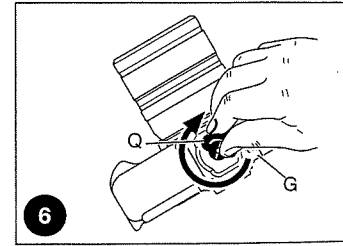
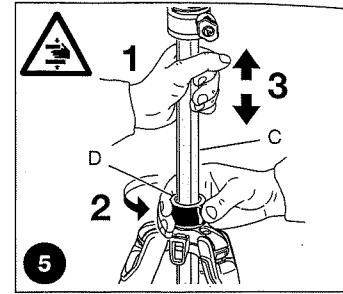
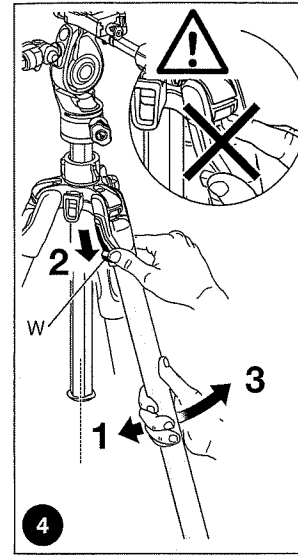
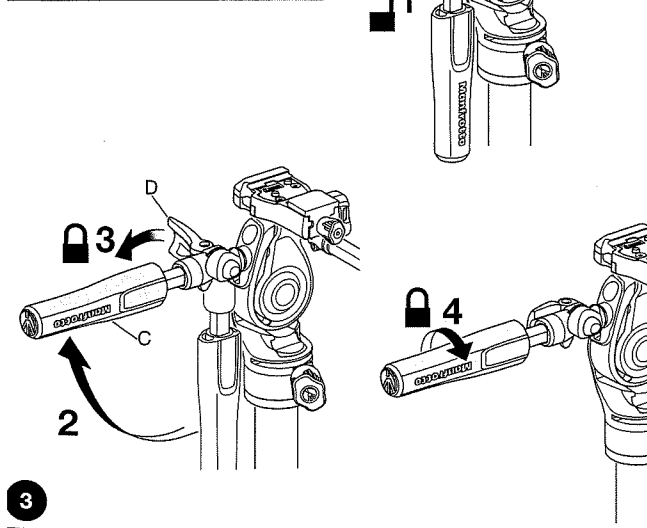
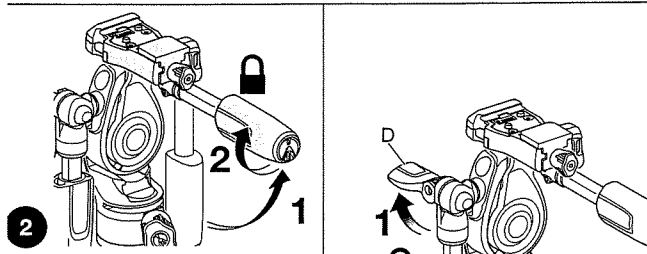
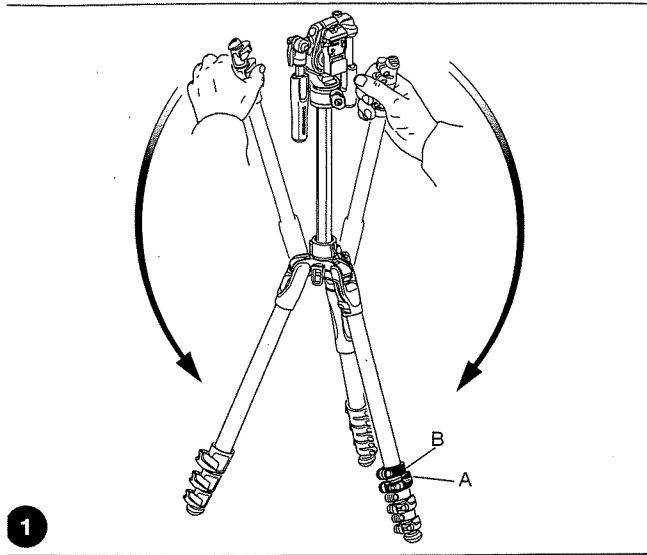

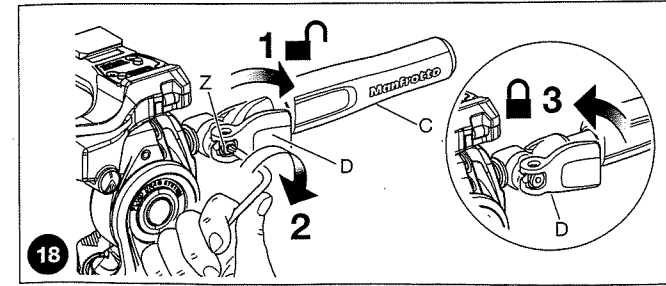
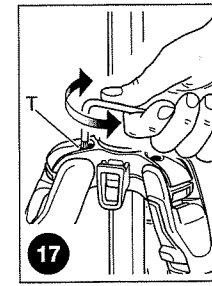
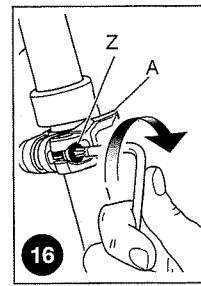
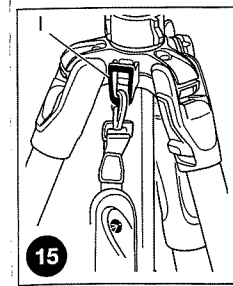
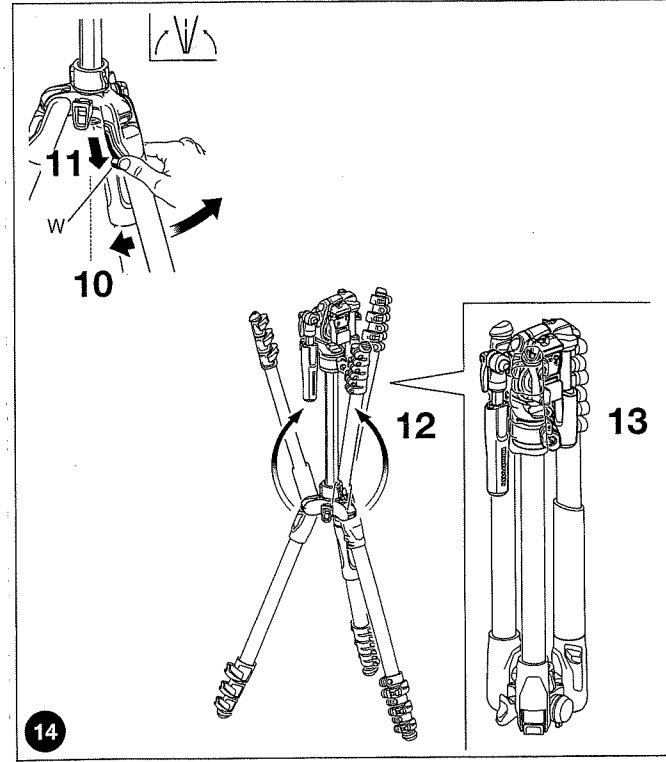
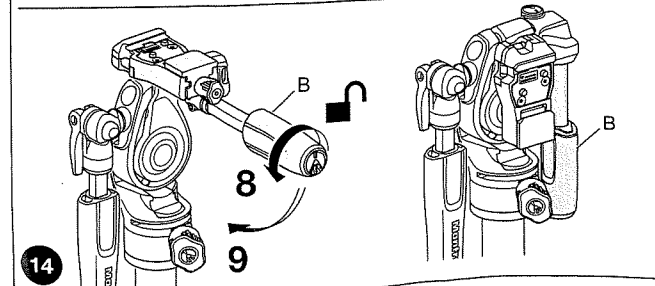
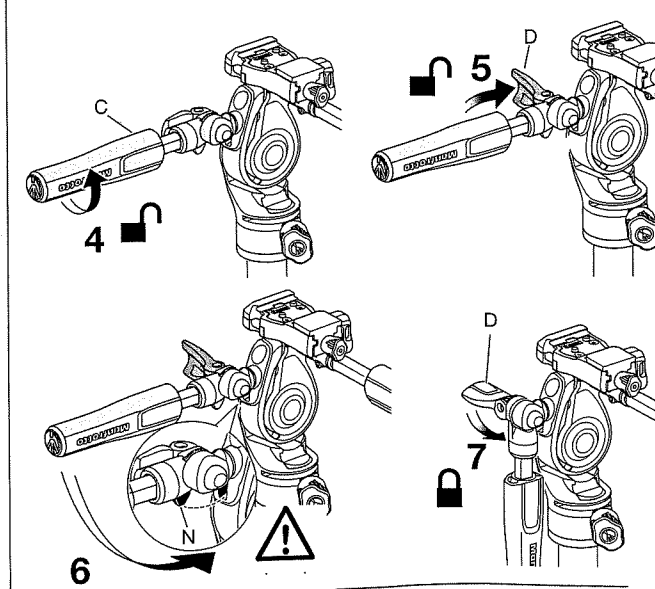
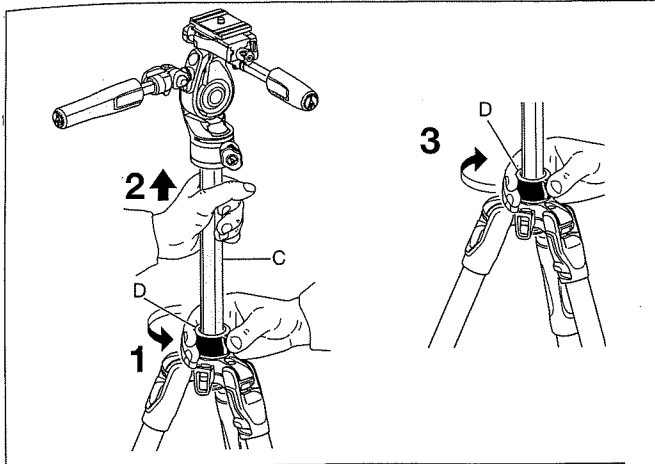
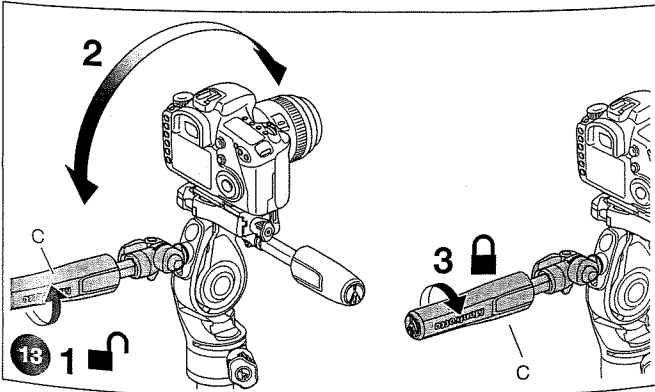
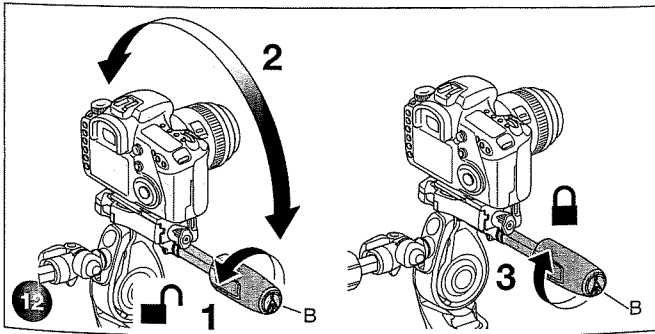
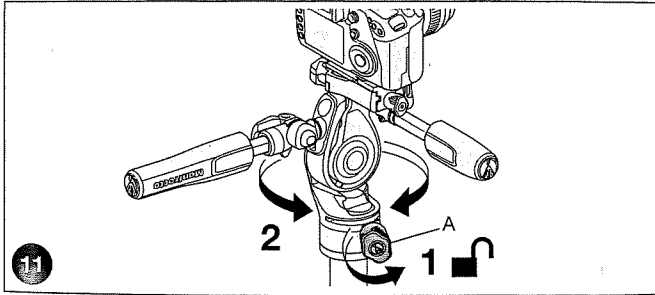
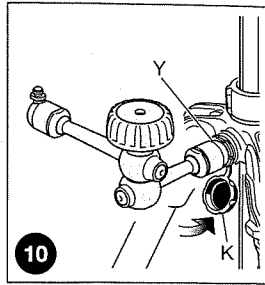
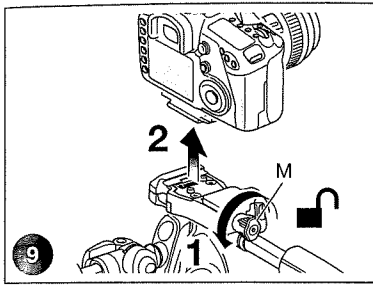
Designed for the advanced travel photographer, this tripod is extremely portable and solid. Ideal for mirrorless cameras, or medium format DSLR.

KEY FEATURES:

- Side-pull leg angle selector for fast adjustment
- Legs can be independently set at 3 angles of spread
- Rubber leg warmer for comfortable grip
- Easy Link socket for arms and other accessories
- Fast and secure locking levers
- Counterweight hook for extra stability and strap attachment

TEMPERATURE RANGE

Working Temperatures between -30°C and +70°C.

Storage Temperatures between -30°C and +70°C.

SET UP 1 2 3

Unfold the legs as shown in fig. 1. Open the 3 tripod legs.

To adjust the tripod's height, release the telescopic extensions on each leg by rotating lever "A" on the locking collar "B".

The head is supplied with foldable handles. Levelling movement handle "B" (fig. 2): unlock the handle, pull up 90° and lock the handle as shown in fig. 2.

Vertical movement handle "C" (fig. 3): unlock the knob "D", pull up the handle "C" 90°, lock knob "D" and then lock the handle "C" as shown in figure 3.

LEG ANGLE ADJUSTMENT 4

Each leg can be set independently at any of the 3 angles of spread.

To change the angle on a leg, close the leg slightly towards the centre column and press down the locking button "W" at the top of the leg. While pressing the button down, select the new leg angle and release button "W" to lock in position, then open the leg fully again.

The angle of each leg can be adjusted independently of the other two legs.

 During this procedure, please take care not to insert your fingers inside the central aperture on the spider collar.

ADJUSTING

CENTRE COLUMN HEIGHT 5

To release the centre column "C", unlock gear "D" and adjust the height of the column as required.

Tighten gear "D" to lock the column in position.

MOUNTING THE PLATE UNDER

THE CAMERA 6

Fix the camera onto plate "G" by screwing camera screw "M" into the camera's threaded hole WITHOUT APPLYING FORCE, using the ring "Q".

Before fully locking, align the camera with the "LENS" marking on the plate "G".

 Please ensure you have securely locked the camera onto the release plate before use

MOUNTING THE CAMERA ON THE

HEAD 7

Push the ring "Q" so that it is flat against the plate "G".

Insert the camera (fig. 7) on top of the head, then tighten knob "M".

OPTIONAL VIDEO PLATE 8

The head is compatible with the Manfrotto 501PL.

 Please fix the plate/camera on the head as shown in fig. 6 to ensure that the plate does not slip when it is unlocked. Insert the camera (fig. 8) on top of the head, then tighten knob "M".

REMOVE THE CAMERA FROM THE

HEAD 9

Whenever the camera needs to be removed from the head, hold the camera securely in one hand while opening locking knob "M", then remove the camera with the other hand.

ATTACHING ACCESSORIES 10

Remove cap "K". The tripod has one 3/8" female thread "Y" (fig. 10) which can be used to attach accessories, such as Manfrotto arms that can in turn support lights, monitors, etc.

USE 11 12 13

Knob "A" (fig. 11) controls 360° panning movement.

Handle "B" (fig. 12) controls levelling movement between +90° and -80°.

Rotate the handle counter-clockwise to allow the head to be moved to the position required and then lock in position by rotating clockwise.

Handle "C" (fig. 13) controls tilting movement between +90° and -45°.

Rotate the handle counter-clockwise to allow the head to be moved to the position required and then lock in position by rotating clockwise.

FOLDING THE TRIPOD 14

Unlock gear "D", raise column "C" to its highest point and then lock it again using gear "D".

- unlock the tilting movement handle "C"
- unlock the knob "D"
- rotate the handle 90° as shown in figure 14, taking care to make the pin "N" fit into the dedicated seat
- lock the handle "D"
- unlock the vertical movement handle "B" and rotate it 90° as shown in figure 14.

Fold the legs slightly towards the centre column "C". Pull each angle selector "W" to release and fold the legs back 180° to close.

TRANSPORTATION 15

The tripod has a hook "I" to attach an optional carrying strap.

LEG LOCK TENSION ADJUSTMENT 16

If the telescopic leg extensions slip after the locking lever "A" has been tightened, or if locking levers "A" have been too stiff to be used, the locking tension needs to be adjusted. To do this, turn screw "Z" clockwise (to tighten) or anticlockwise (to loosen) using a TORX key number 20. As reference we suggest to apply 1/3 of a turn to restore the proper tension.

SPIDER COLLAR TENSION

ADJUSTMENT 17

If the leg tension is too weak or too stiff, compromising the proper product use, the spider collar tension needs to be adjusted. To do this, turn screw "T" clockwise (to tighten) or anticlockwise (to loosen) using a TORX key number 25. As reference we suggest to apply 1/3 of a turn to restore the proper tension.

HANDLE LOCK TENSION

ADJUSTMENT 18

If the head tends to move despite having tightened lever "C", an adequate clamping force must be restored. To do this, open lever "D" slightly (fig. 18), tighten the screw "Z" clockwise using the number 20 TORX wrench supplied and close lever "D". A third of a turn (1/3) rotation should normally be enough to restore the correct handle lock tension.

Progettato per esperti fotografi che amano viaggiare, questo treppiedi è estremamente portatile e solido. Ideale per fotocamere mirrorless o DSLR di medio formato.

Caratteristiche chiave:

- Selettore per l'ampiezza dell'angolo di gamba che consente una veloce regolazione
- Le gambe possono essere regolate ad ampiezza diversa indipendentemente
- Protezione in gomma sulla gamba per un grip confortevole
- Connettore per attaccare facilmente braccetti e accessori
- Leve di bloccaggio veloci e sicure
- Gancio per contrappeso e per la cinghia porta treppiedi

INTERVALLI DI TEMPERATURA

Intervallo di temperatura di utilizzo -30 °C - +70 °C.

Intervallo di temperatura di stoccaggio -30 °C - +70 °C.

SET UP 1 2 3

Aprire le gambe come mostrato nella fig. 1. Aprire le 3 gambe del treppiedi.

Per regolare l'altezza del treppiedi, liberare le sezioni telescopiche di ciascuna gamba ruotando la leva "A" sul manicotto "B". La testa è provvista di leve pieghevoli.

Leva di controllo del movimento di livellamento "B" (fig. 2): sbloccare la leva, sollevarla a 90° e bloccarla nuovamente come mostrato in figura 2.

Leva di controllo del movimento verticale "C" (fig. 3): sbloccare la manopola "D", sollevare la leva "C" a 90°, bloccare la manopola "D" e quindi bloccare la leva "C" come mostrato in figura 3.

REGOLAZIONE

DELL'ANGOLAZIONE DI GAMBA 4

Ciascuna gamba può essere regolata indipendentemente con 3 angoli di ampiezza. Per cambiare l'angolo di apertura di una gamba, chiudere leggermente la gamba verso la Colonna centrale e premere il pulsante di chiusura "W" in cima alla gamba.

Mentre premete il pulsante, selezionate il nuovo angolo di apertura e rilasciate il pulsante "W" per bloccare la gamba in quella posizione, in seguito riaprire completamente la gamba.

L'angolo di ciascuna gamba può essere regolata indipendentemente da quella delle altre due.

 Durante questa procedura, fare attenzione a non inserire le dita all'interno dell'apertura centrale sulla crociera.

REGOLAZIONE

DELLA COLONNA CENTRALE 5

Per rilasciare la Colonna centrale "C", sbloccare la manopola "D" e regolare l'altezza della colonna come desiderato. In seguito stringere la manopola "D" per bloccare la colonna.